

ADJUSTABLE STEEL GANTRY CRANE - AHS-8-15-16

APPROX WEIGHT: 1125.24 lbs.
DOES NOT INCLUDE WEIGHT OF POWER OR PACKAGING!!!

*** ANY ADDITIONS, DELETIONS, OR OMISSIONS MUST BE CORRECTED ON THIS DRAWING AS THIS DRAWING WILL BE CONSIDERED ALL INCLUSIVE ***

ALL GRAPHICS PROVIDED ARE FOR REFERENCE ONLY. IF CERTAIN DIMENSIONS ARE CRITICAL PLEASE VERIFY THOSE DIMENSIONS WITH YOUR SALESPERSON

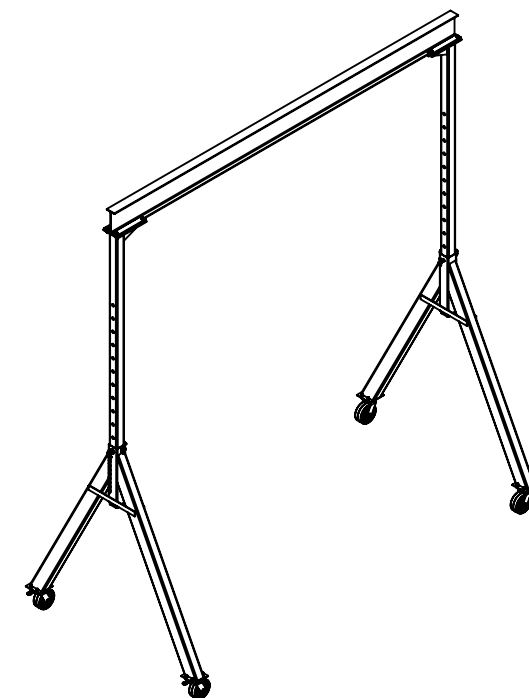
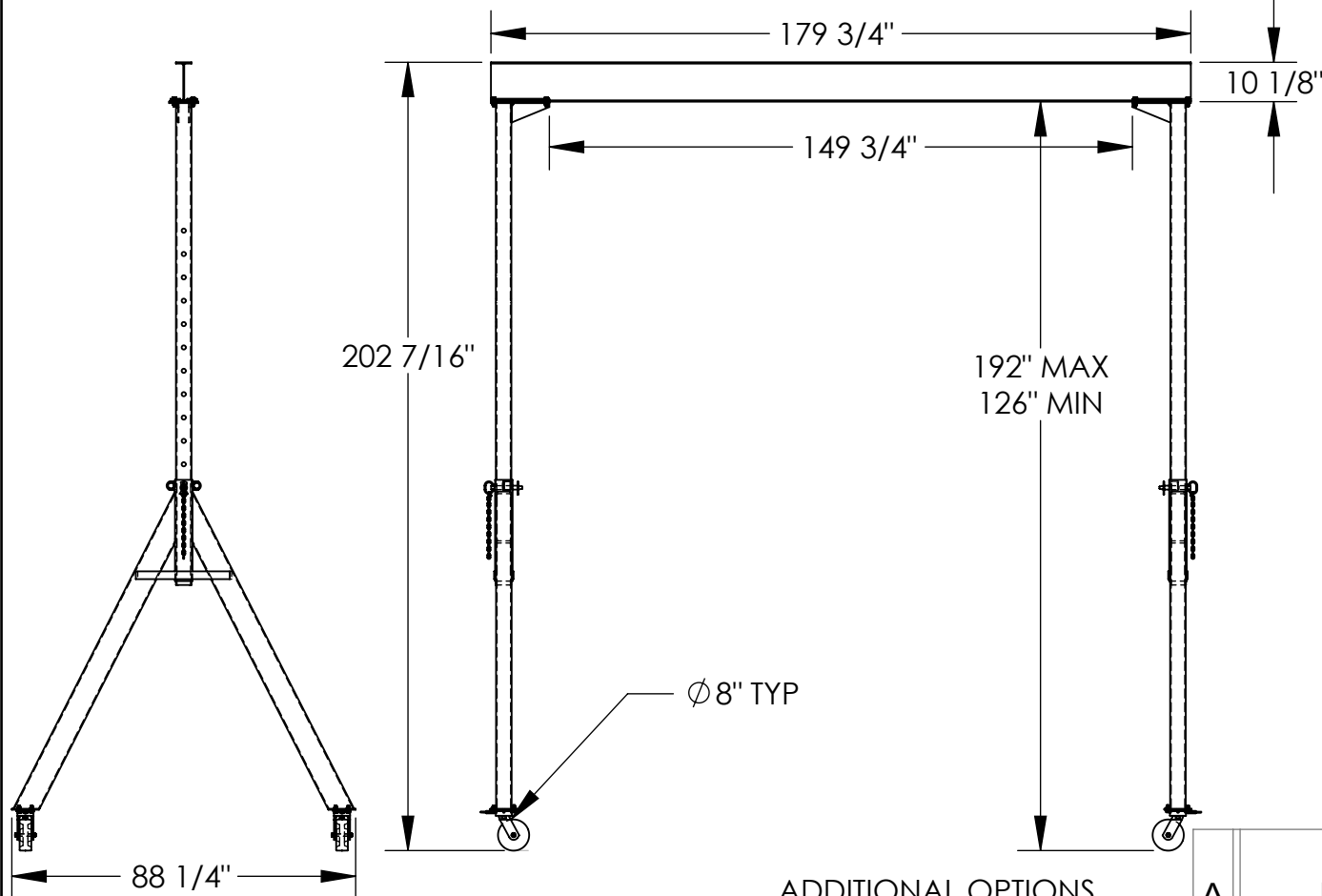

3D VIEW FOR REFERENCE ONLY

STANDARD FEATURES

MODEL NUMBER IS AHS-8-15-16
CAPACITY IS 8,000 LBS.
BASE WIDTH IS 88 1/4"
OVERALL HEIGHT IS 202 7/16"
OVERALL I-BEAM LENGTH IS 179 3/4"
USABLE I-BEAM LENGTH IS 149 3/4"
ADJUSTABLE UNDER I-BEAM
HEIGHT - 126" MIN. TO 192" MAX.
I-BEAM HEIGHT IS 10 1/8"
CASTERS: (4) 8" X 3" SWIVEL PHENOLIC
WITH FOUR POSITION LOCKING

ADDITIONAL OPTIONS

MANUAL TROLLIES		
1,000 # CAPACITY	2,000 # CAPACITY	4,000 # CAPACITY
QIT-1	QIT-2	QIT-4
E-MT-1	E-MT-2	E-MT-4
E-MT-1-C	E-MT-2-C	E-MT-4-C
6,000 # CAPACITY	8,000 # CAPACITY	
QIT-6	QIT-8	
E-MT-6	E-MT-8	
E-MT-6-C	E-MT-8-C	

**CAPACITY OF ATTACHMENTS MAY
DERATE CAPACITY OF GANTRY CRANE

APPROVAL

I, THE UNDERSIGNED, AGREE THAT THE PRODUCT AS REPRESENTED SATISFIES DESIGN AND DIMENSION REQUIREMENTS. I ALSO ACKNOWLEDGE MY DUTY TO CONFIRM PRODUCT AND INSTALLATION COMPLIANCE WITH ALL APPLICABLE FEDERAL, STATE AND LOCAL REGULATIONS AND STANDARDS.

ALL SPECIAL UNITS ARE NON-RETURNABLE

[] As drawn [] As marked

Signed: _____ Date: _____

LEAD TIME WILL START UPON RECEIPT
OF SIGNED APPROVAL DRAWING

DISTRIBUTOR'S NAME:

VESTIL MANUFACTURING

P.O.#

W.O.#

DRAWN BY: ND

DATE: 10/1/09

SALES: X

REFERENCE: X

SCALE: 1:49

FILE NAME:

QUOTED LEAD TIME: X

QUOTE #
X

28-007-176