

# ADJUSTABLE STEEL GANTRY CRANE - AHS-10-15-10

APPROX WEIGHT: 1024.33 lbs. DOES NOT INCLUDE WEIGHT OF POWER OR PACKAGING!!!

\*\*\* ANY ADDITIONS, DELETIONS, OR OMISSIONS MUST BE CORRECTED ON THIS DRAWING AS THIS DRAWING WILL BE CONSIDERED ALL INCLUSIVE \*\*\*

ALL GRAPHICS PROVIDED ARE FOR REFERENCE ONLY. IF CERTAIN DIMENSIONS ARE CRITICAL PLEASE VERIFY THOSE DIMENSIONS WITH YOUR SALESPERSON

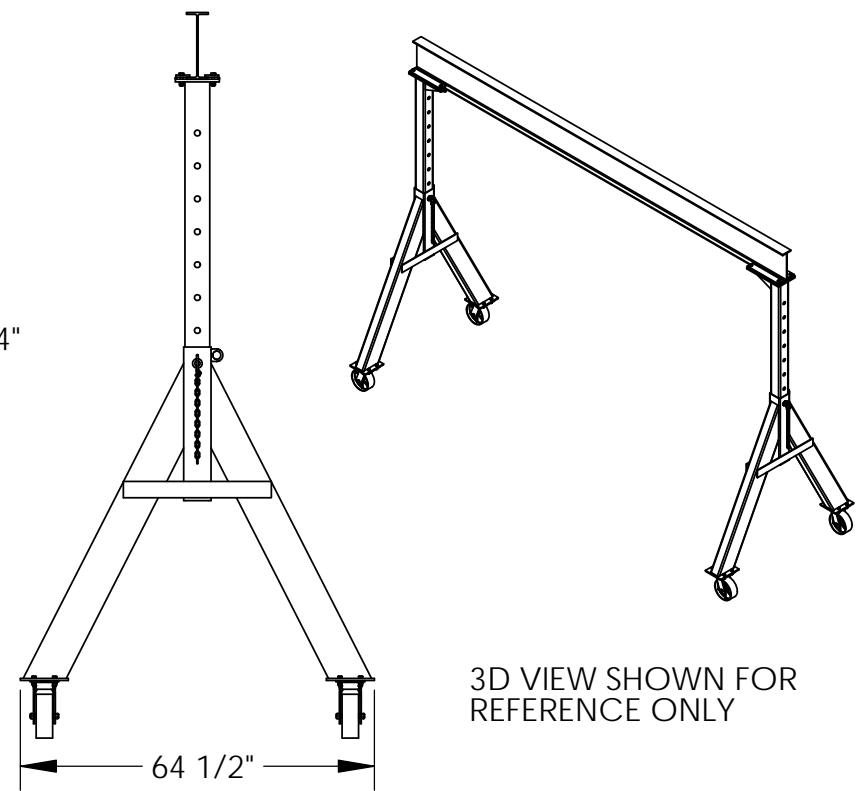
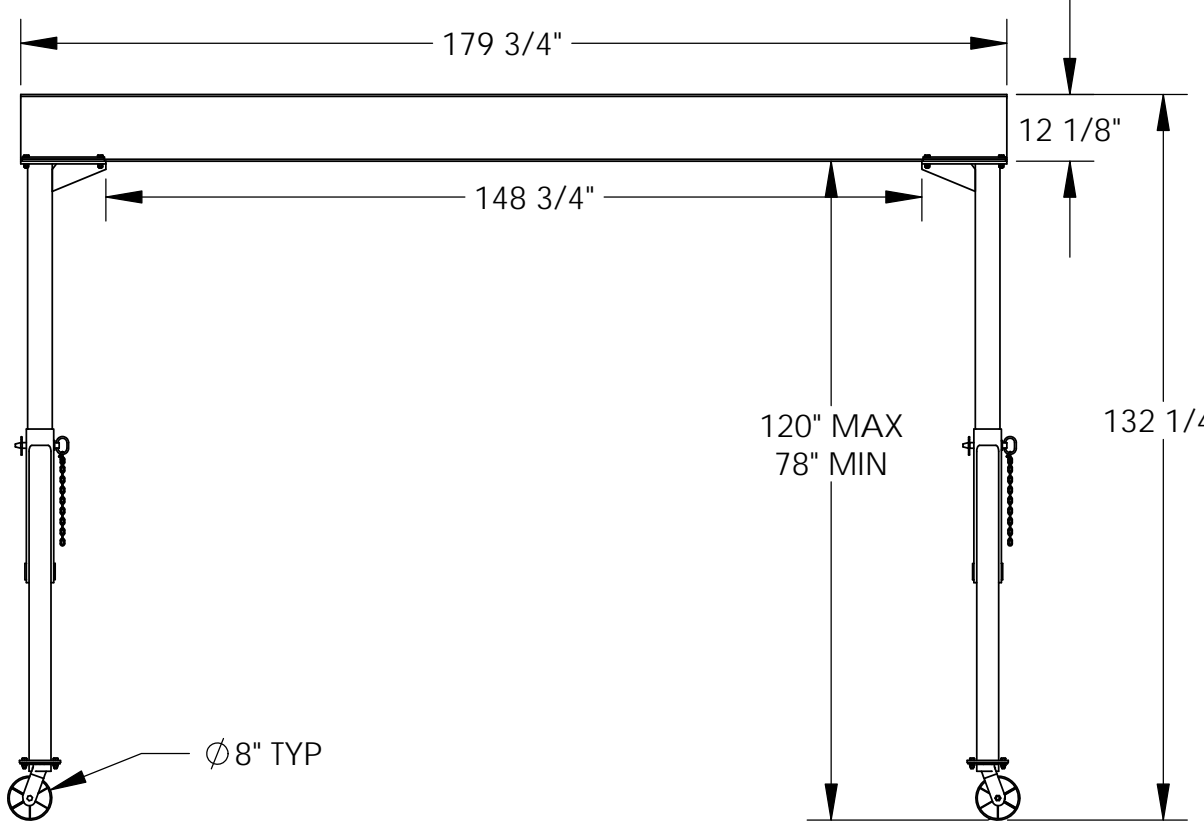

3D VIEW SHOWN FOR REFERENCE ONLY

## STANDARD FEATURES

MODEL NUMBER IS AHS-10-15-10  
 CAPACITY IS 10,000 LBS.  
 BASE WIDTH IS 64 1/2"  
 OVERALL HEIGHT IS 132 1/4"  
 OVERALL I-BEAM LENGTH IS 179 3/4"  
 USABLE I-BEAM LENGTH IS 148 3/4"  
 ADJUSTABLE UNDER I-BEAM  
 HEIGHT - 78" MIN. TO 120" MAX.  
 I-BEAM HEIGHT IS 12 1/8"  
 CASTERS: (4) 8" X 3" SWIVEL WITH  
 FOUR POSITION LOCKING

## SPECIAL FEATURES

NONE

## ADDITIONAL OPTIONS

MANUAL TROLLIES		
1,000 # CAPACITY	2,000 # CAPACITY	4,000 # CAPACITY
QIT-1	QIT-2	QIT-4
E-MT-1	E-MT-2	E-MT-4
E-MT-1-C	E-MT-2-C	E-MT-4-C
6,000 # CAPACITY	8,000 # CAPACITY	10,000 # CAPACITY
QIT-6	QIT-8	QIT-10
E-MT-6	E-MT-8	E-MT-10
E-MT-6-C	E-MT-8-C	E-MT-10-C

\*\*CAPACITY OF ATTACHMENTS MAY DERATE CAPACITY OF GANTRY CRANE

I, THE UNDERSIGNED, AGREE THAT THE PRODUCT AS REPRESENTED SATISFIES DESIGN AND DIMENSION REQUIREMENTS. I ALSO ACKNOWLEDGE MY DUTY TO CONFIRM PRODUCT AND INSTALLATION COMPLIANCE WITH ALL APPLICABLE FEDERAL, STATE AND LOCAL REGULATIONS AND STANDARDS.

**ALL SPECIAL UNITS ARE NON-RETURNABLE**  
 As drawn     As marked

Signed: \_\_\_\_\_ Date: \_\_\_\_\_

LEAD TIME WILL START UPON RECEIPT OF SIGNED APPROVAL DRAWING

DISTRIBUTOR'S NAME:		P.O.#
VESTIL MANUFACTURING		X
DRAWN BY: ND		W.O.#
DATE: 10/7/09		X
REFERENCE: X	SCALE: 1:35	SALES: X
QUOTED LEAD TIME: X	QUOTE # X	FILE NAME:
		28-007-215