

# FIXED STEEL GANTRY CRANE - FHS-2-15

APPROX WEIGHT: 654.33 lbs.  
DOES NOT INCLUDE WEIGHT OF POWER OR PACKAGING!!!

\*\*\* ANY ADDITIONS, DELETIONS, OR OMISSIONS MUST BE CORRECTED ON THIS DRAWING AS THIS DRAWING WILL BE CONSIDERED ALL INCLUSIVE \*\*\*  
ALL GRAPHICS PROVIDED ARE FOR REFERENCE ONLY. IF CERTAIN DIMENSIONS ARE CRITICAL PLEASE VERIFY THOSE DIMENSIONS WITH YOUR SALESPERSON

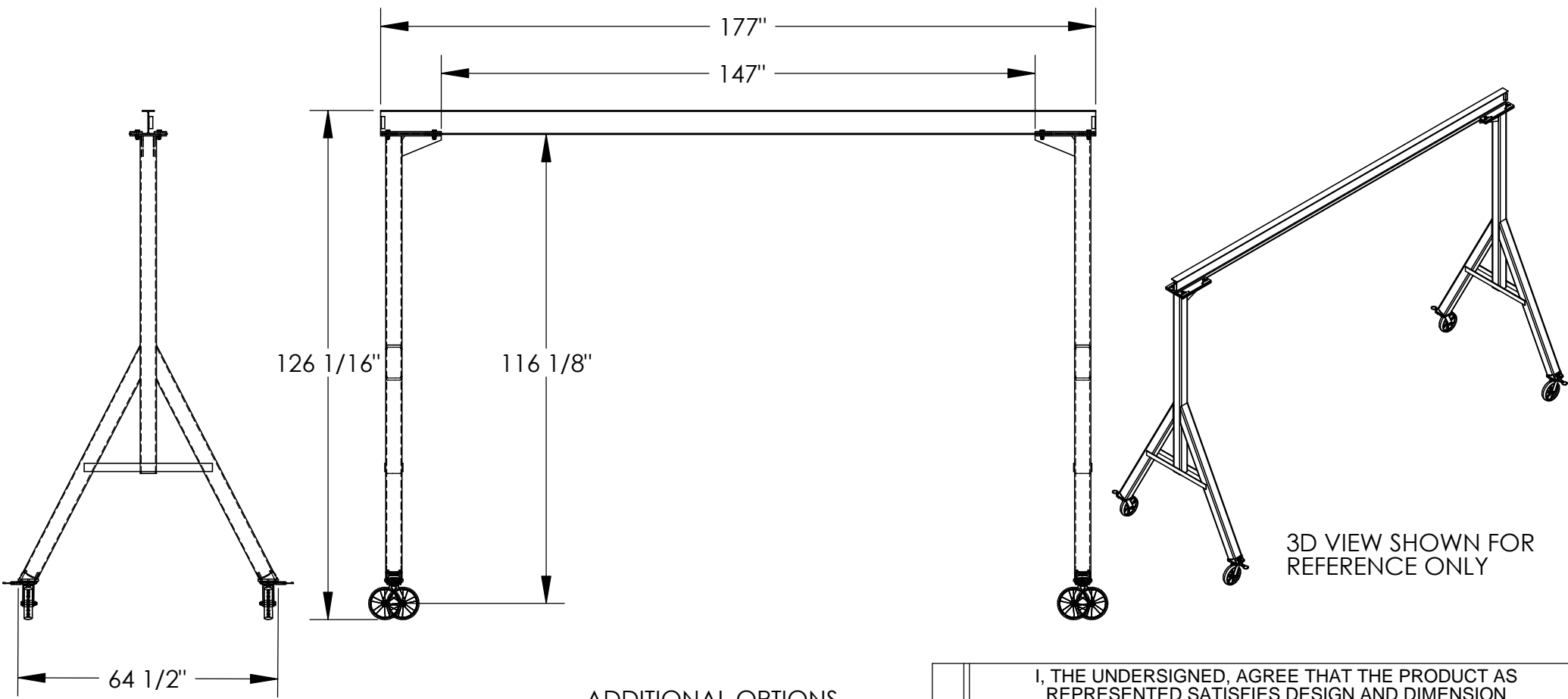

## STANDARD FEATURES

MODEL NUMBER IS FHS-2-15  
OVERALL WIDTH IS 64 1/2"  
USABLE WIDTH IS 64 1/2"  
OVERALL LENGTH IS 177"  
USABLE LENGTH IS 147"  
OVERALL HEIGHT IS 126"  
UNDER I-BEAM HEIGHT IS 10"  
CAPACITY IS 2000 LBS.  
OVERALL BEAM LENGTH IS 177"  
OVERALL BEAM HEIGHT IS 6"  
CASTERS: (4) 8" X 2" SWIVEL WITH FOUR LOCKING POSITION

## ADDITIONAL OPTIONS

| MANUAL TROLLIES  |                  |
|------------------|------------------|
| 1,000 # CAPACITY | 2,000 # CAPACITY |
| QIT-1            | QIT-2            |
| E-MT-1           | E-MT-2           |
| E-MT-1-C         | E-MT-2-C         |

\*\*CAPACITY OF ATTACHMENTS MAY DERATE CAPACITY OF GANTRY CRANE

I, THE UNDERSIGNED, AGREE THAT THE PRODUCT AS REPRESENTED SATISFIES DESIGN AND DIMENSION REQUIREMENTS. I ALSO ACKNOWLEDGE MY DUTY TO CONFIRM PRODUCT AND INSTALLATION COMPLIANCE WITH ALL APPLICABLE FEDERAL, STATE AND LOCAL REGULATIONS AND STANDARDS.

**ALL SPECIAL UNITS ARE NON-RETURNABLE**  
[ ] As drawn [ ] As marked

Signed: \_\_\_\_\_ Date: \_\_\_\_\_

LEAD TIME WILL START UPON RECEIPT OF SIGNED APPROVAL DRAWING

|                      |             |            |
|----------------------|-------------|------------|
| DISTRIBUTOR'S NAME:  |             | P.O.#      |
| VESTIL MANUFACTURING |             | X          |
| DRAWN BY: ND         |             | W.O.#      |
| DATE: 9/30/09        |             | X          |
| REFERENCE: X         | SCALE: 1:36 | SALES: X   |
| QUOTED LEAD TIME: X  | QUOTE # X   | FILE NAME: |
|                      |             | 28-007-062 |