

**J904B BASE MOUNTED JIB CRANE GENERAL ARRANGEMENT**

NOTE: 1. BASE PLATE O.D. 6" LARGER THAN BOLT CIRCLE.  
 \*2. MODEL NO. 300 (HEAVY), 360 & 420 HAS SHIMS ON TOP OF HEAD ASSY. UNDER BOOM.  
 \*\*3. "L" DIM. FOR MODEL 300L IS 7'-0".

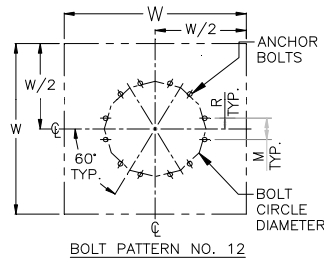
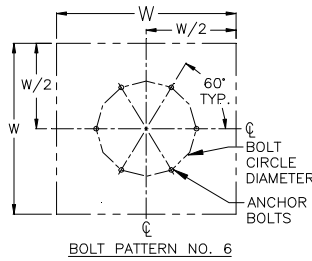

CATALOG MODEL: 4B0198

MODEL NO.: J-904-080-W06B

CAPACITY: 1/2 TON (1000#)

WEIGHT: 940

A 10'-0"

B 10'-0"

C 10'-6 1/4"

D W6X16 - D 6 1/4", FW 4"

E 3'-0"

W 4'-0"

SALES NO:

CUST. ORDER NO:

CUSTOMER:

**RECOMMENDED INSTALLATION PROCEDURE**

SEE BULLETIN I.I. J-904B INSTALLATION INSTRUCTIONS FOR BASE MOUNTED PILLAR JIB CRANE MODEL J-904B.

**RECOMMENDED FOUNDATION CONCRETE**

JIB CRANE FOUNDATION REQUIREMENTS ARE BASED ON A SOIL PRESSURE OF 2500 LBS. PER SQUARE FOOT. 3000 LBS. P.S.I. (PER SQ. INCH) COMPRESSIVE CONCRETE (5 BAG MIX-ONE YARD OF CONCRETE).

ABELL-HOWE CRANES, ASSUMES NO RESPONSIBILITY FOR LOADING IMPOSED ON BUILDING STRUCTURE OR FOOTINGS BY THIS EQUIPMENT. WE SUGGEST THIS BE CHECKED BY A LICENSED STRUCTURAL ENGINEER AND ANY NECESSARY PERMITS BE SECURED.

	MODEL NO.	DIMENSIONS				ANCHOR BOLTS			
		F1	F2	Z	L	PATT NO.	B.C. DIA	BOLT DIA.	P
<b>X</b>	J-904B-080	1'-0 1/8"	1'-1 1/2"	1'-1 5/8"	4'-0"	6	24"	1"	4 3/4"
	120	1'-3"	1'-5 1/4"	1'-5 1/8"	4'-6"	6	30"	1 1/4"	5 1/2"
	140	1'-5"	1'-7 1/2"	1'-7"	4'-6"	6	36"	1 1/4"	5 1/2"
	160	1'-4 3/8"	1'-7 3/4"	1'-7 3/4"	5'-0"	12	42"	1 1/4"	5 1/2"
	180	1'-6 3/8"	1'-9 1/2"	1'-9 3/4"	5'-0"	12	48"	1 1/4"	5 1/2"
	200	1'-8 3/8"	1'-11 3/4"	1'-10 3/4"	5'-0"	12	54"	1 1/4"	5 1/2"
	240	1'-11 1/8"	2'-3 1/4"	2'-1 1/8"	6'-5"	12	60"	1 1/4"	5 1/2"
	300H **	2'-2"	2'-7 1/2"	2'-7"	8'-0"	12	66"	1 1/4"	5 1/2"
	360	2'-5"	2'-11 3/4"	2'-10 3/4"	8'-0"	6	72"	2 1/2"	8"
	420	3'-0"	3'-6 7/8"	3'-3"	10'-10"	6	78"	3"	9"

INSTALLATION DRAWING 360° BASE MOUNTED	
PILLAR JIB CRANE MODEL J-904B	
<b>ABELL-HOWE CRANES</b>	
DIVISION OF CRANE, EQUIPMENT & SERVICE, INC.	
10321 WERCH DR. UNIT 100, WOODRIDGE, ILLINOIS 60517	
SCALE: NONE	CHECKED BY:
DRAWN BY: RKN	APPROVED BY:
DATE: 9/19/2006	
DWG NO.: A3-J904B	SHEET NO. 1 OF 1