

APPROX WEIGHT: 849.80 lbs.
DOES NOT INCLUDE WEIGHT OF POWER OR PACKAGING!!!

ADJUSTABLE STEEL GANTRY CRANE - AHS-6-10-12

*** ANY ADDITIONS, DELETIONS, OR OMISSIONS MUST BE CORRECTED ON THIS DRAWING AS THIS DRAWING WILL BE CONSIDERED ALL INCLUSIVE ***
ALL GRAPHICS PROVIDED ARE FOR REFERENCE ONLY. IF CERTAIN DIMENSIONS ARE CRITICAL PLEASE VERIFY THOSE DIMENSIONS WITH YOUR SALESPERSON

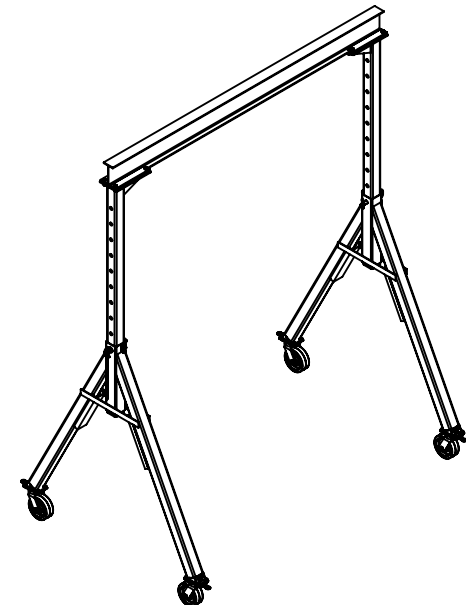
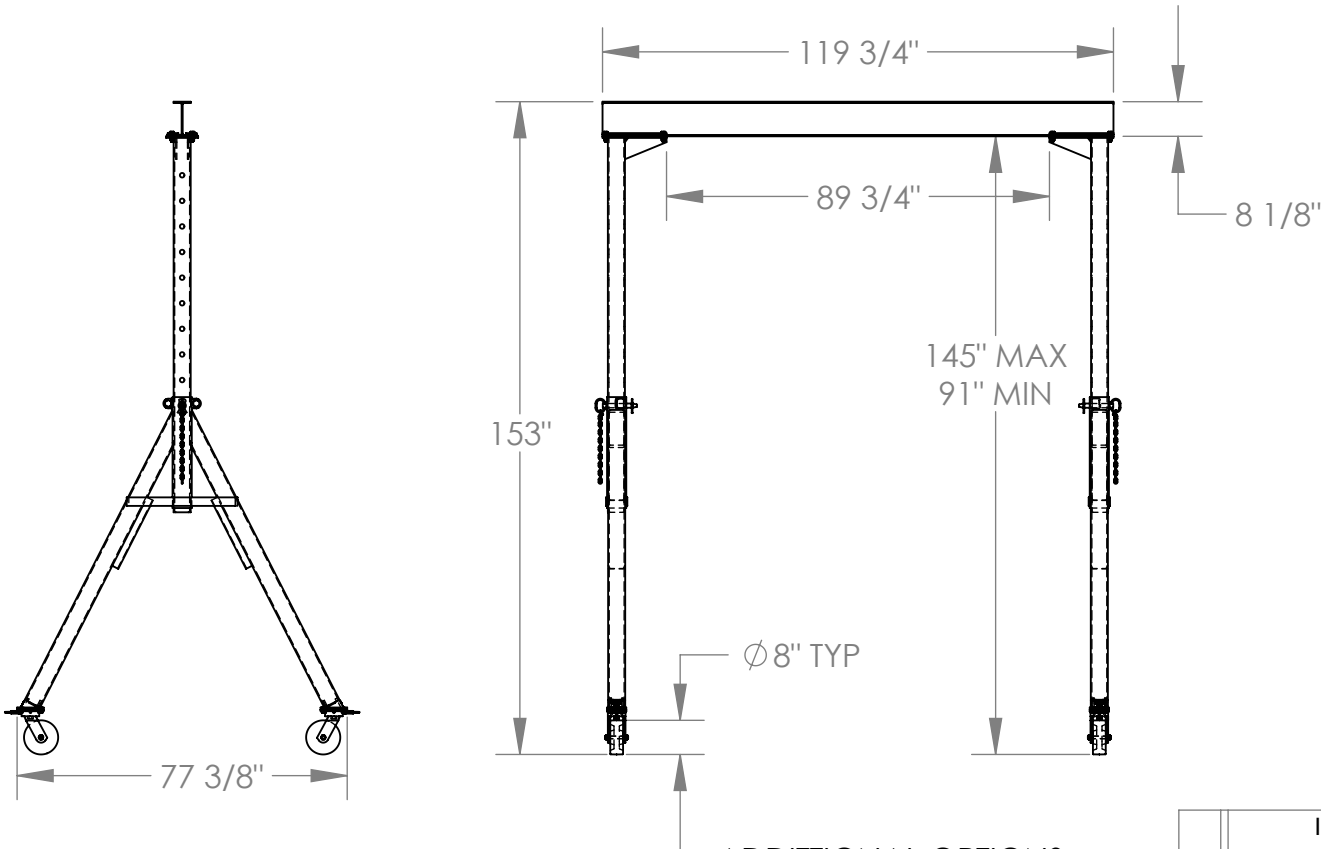

3D VIEW FOR REFERENCE ONLY

STANDARD FEATURES

MODEL NUMBER IS AHS-6-10-12
CAPACITY IS 6,000 LBS.
BASE WIDTH IS 77 3/8"
OVERALL HEIGHT IS 153"
OVERALL I-BEAM LENGTH IS 119 3/4"
USABLE I-BEAM LENGTH IS 89 3/4"
ADJUSTABLE UNDER I-BEAM
HEIGHT - 91" MIN. TO 145" MAX.
I-BEAM HEIGHT IS 8 1/8"
(4) Ø8" SWIVEL CASTERS WITH
FOUR LOCKING POSITIONS

ADDITIONAL OPTIONS

MANUAL TROLLIES			
1,000 # CAPACITY	2,000 # CAPACITY	4,000 # CAPACITY	6,000 # CAPACITY
QIT-1	QIT-2	QIT-4	QIT-6
E-MT-1	E-MT-2	E-MT-4	E-MT-6
E-MT-1-C	E-MT-2-C	E-MT-4-C	E-MT-6-C

**CAPACITY OF ATTACHMENTS MAY
DERATE CAPACITY OF GANTRY CRANE

APPROVAL

I, THE UNDERSIGNED, AGREE THAT THE PRODUCT AS REPRESENTED SATISFIES DESIGN AND DIMENSION REQUIREMENTS. I ALSO ACKNOWLEDGE MY DUTY TO CONFIRM PRODUCT AND INSTALLATION COMPLIANCE WITH ALL APPLICABLE FEDERAL, STATE AND LOCAL REGULATIONS AND STANDARDS.
ALL SPECIAL UNITS ARE NON-RETURNABLE
[] As drawn [] As marked
Signed: _____ Date: _____
LEAD TIME WILL START UPON RECEIPT OF SIGNED APPROVAL DRAWING

DISTRIBUTOR'S NAME:		P.O.#
VESTIL MANUFACTURING		X
DRAWN BY: ND		W.O.#
DATE: 10/1/09		X
REFERENCE: X	SCALE: 1:45	SALES: X
QUOTED LEAD TIME: X	QUOTE # X	FILE NAME:
		28-007-080