

APPROX WEIGHT: 746.80 lbs.  
DOES NOT INCLUDE WEIGHT OF POWER OR PACKAGING!!!

# ADJUSTABLE STEEL GANTRY CRANE - AHS-4-10-12

\*\*\* ANY ADDITIONS, DELETIONS, OR OMISSIONS MUST BE CORRECTED ON THIS DRAWING AS THIS DRAWING WILL BE CONSIDERED ALL INCLUSIVE \*\*\*  
ALL GRAPHICS PROVIDED ARE FOR REFERENCE ONLY. IF CERTAIN DIMENSIONS ARE CRITICAL PLEASE VERIFY THOSE DIMENSIONS WITH YOUR SALESPERSON

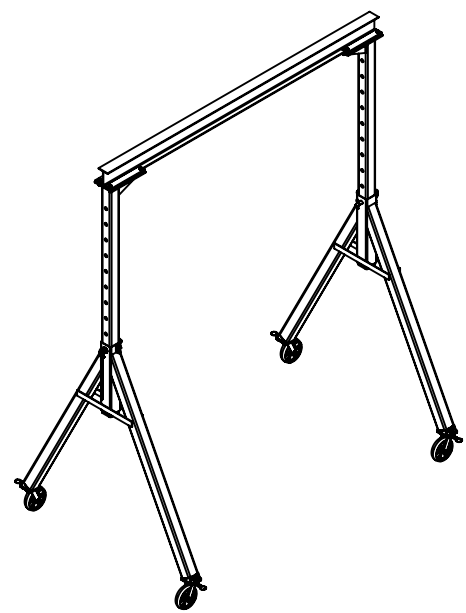
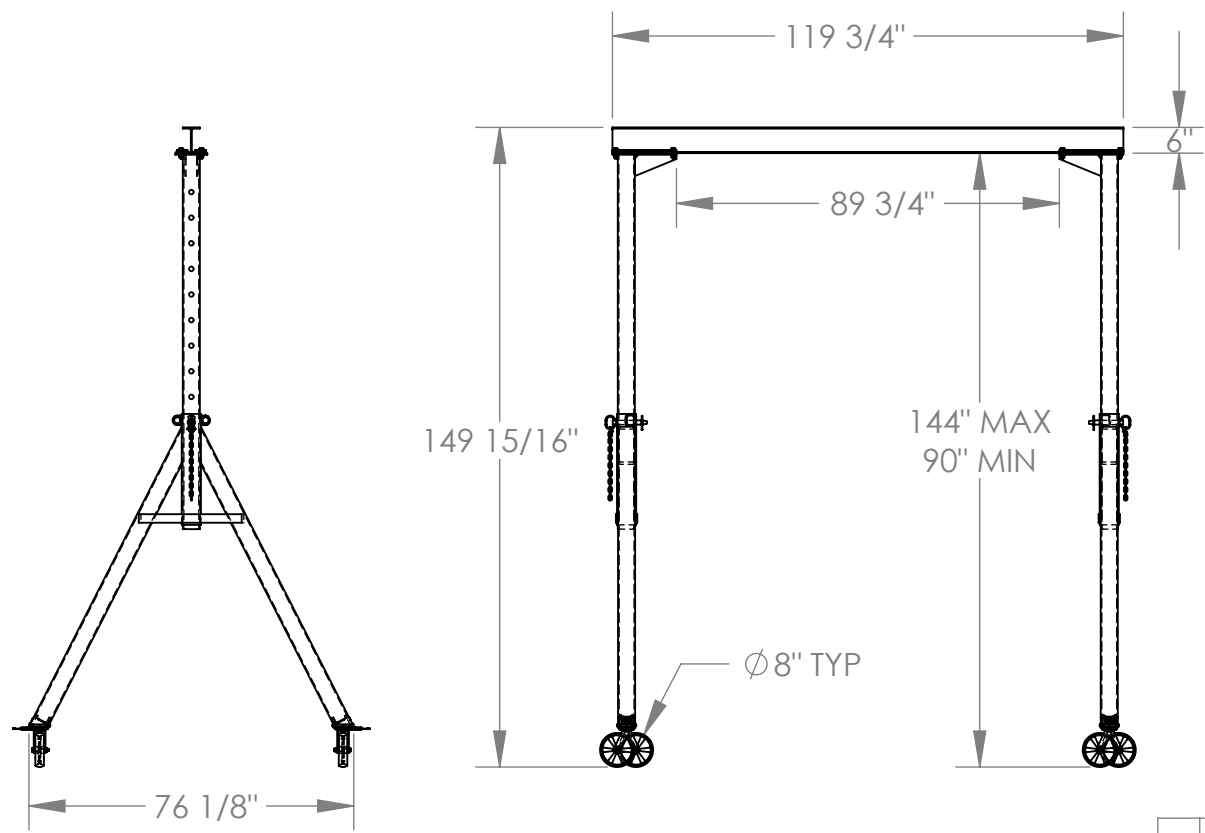

3D VIEW FOR REFERENCE ONLY

## STANDARD FEATURES

MODEL NUMBER IS AHS-4-10-12  
CAPACITY IS 4000 LBS.  
BASE WIDTH IS 76 1/8"  
OVERALL HEIGHT IS 149 15/16"  
OVERALL BEAM LENGTH IS 119 3/4"  
USABLE BEAM LENGTH IS 89 3/4"  
OVERALL HEIGHT IS 149 15/16"  
UNDER I-BEAM HEIGHT IS 90" TO 144"  
I-BEAM HEIGHT IS 6"  
CASTERS: (4) 8" X 2" SWIVEL WITH  
FOUR LOCKING POSITION

## ADDITIONAL OPTIONS

MANUAL TROLRIES		
1,000 # CAPACITY QIT-1	2,000 # CAPACITY QIT-2	4,000 # CAPACITY QIT-4
E-MT-1	E-MT-2	E-MT-4
E-MT-1-C	E-MT-2-C	E-MT-4-C

\*\*CAPACITY OF ATTACHMENTS MAY  
DERATE CAPACITY OF GANTRY CRANE

APPROVAL

I, THE UNDERSIGNED, AGREE THAT THE PRODUCT AS REPRESENTED SATISFIES DESIGN AND DIMENSION REQUIREMENTS. I ALSO ACKNOWLEDGE MY DUTY TO CONFIRM PRODUCT AND INSTALLATION COMPLIANCE WITH ALL APPLICABLE FEDERAL, STATE AND LOCAL REGULATIONS AND STANDARDS.

**ALL SPECIAL UNITS ARE NON-RETURNABLE**  
[ ] As drawn [ ] As marked

Signed: \_\_\_\_\_ Date: \_\_\_\_\_

LEAD TIME WILL START UPON RECEIPT OF SIGNED APPROVAL DRAWING

DISTRIBUTOR'S NAME:		P.O.#
VESTIL MANUFACTURING		X
DRAWN BY: ND		W.O.#
DATE: 10/1/09		X
REFERENCE: X	SCALE: 1:45	SALES: X
QUOTED LEAD TIME: X	QUOTE # X	FILE NAME:
		28-007-074