

# ADJUSTABLE ALUMINUM GANTRY CRANE - AHA-6-15-8

APPROX WEIGHT: 478.93 lbs.  
DOES NOT INCLUDE WEIGHT OF POWER OR PACKAGING!!!

\*\*\* ANY ADDITIONS, DELETIONS, OR OMISSIONS MUST BE CORRECTED ON THIS DRAWING AS THIS DRAWING WILL BE CONSIDERED ALL INCLUSIVE \*\*\*  
ALL GRAPHICS PROVIDED ARE FOR REFERENCE ONLY. IF CERTAIN DIMENSIONS ARE CRITICAL PLEASE VERIFY THOSE DIMENSIONS WITH YOUR SALESPERSON

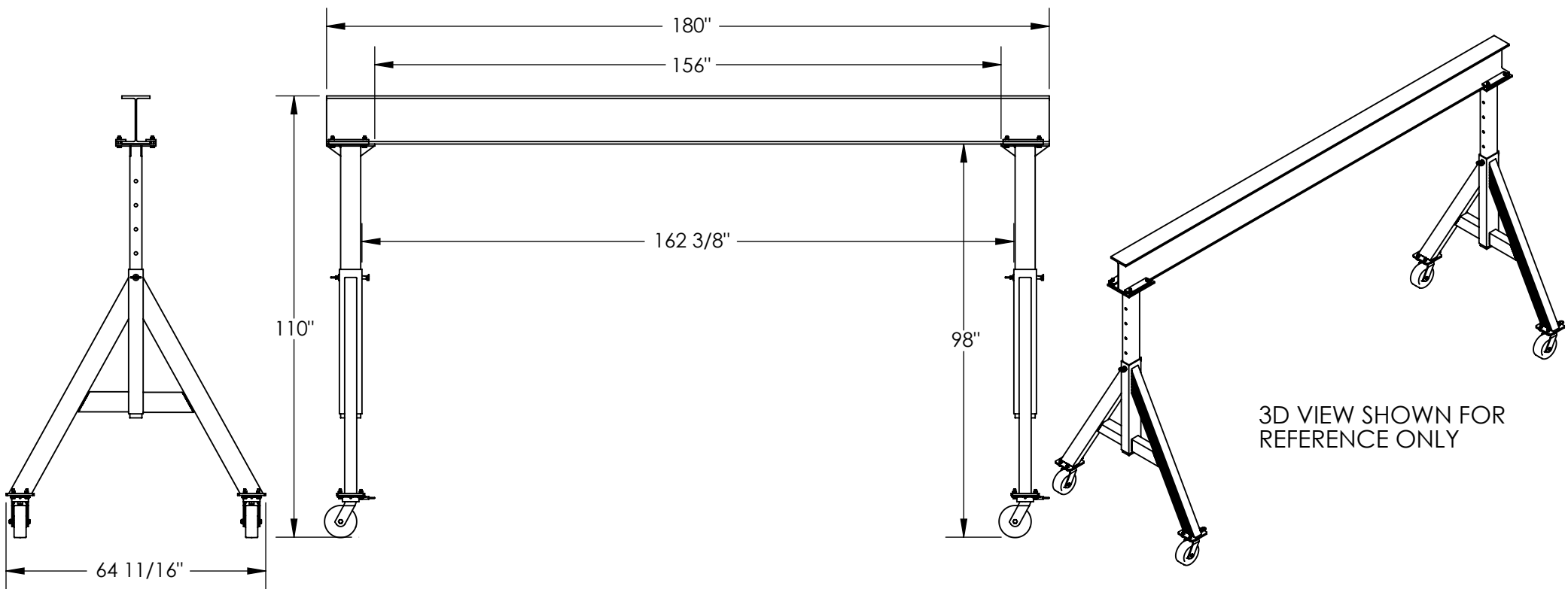

## STANDARD FEATURES

MODEL NUMBER IS AHA-6-15-8  
MAX CAPACITY IS 6,000 LBS.  
OVERALL BASE WIDTH IS 64 11/16"  
OVERALL I-BEAM LENGTH IS 180"  
USABLE I-BEAM LENGTH IS 156"  
OVERALL HEIGHT IS 110"  
UNDER I-BEAM HEIGHT IS 6' 2" TO 8' 2"  
12" I-BEAM  
STRADDLE I.D. IS APPROX. 162 3/8"  
CASTERS: (4) Ø8" PHENOLIC  
SWIVEL WITH FOUR  
LOCKING POSITIONS

## SPECIAL FEATURES

NONE

## ADDITIONAL OPTIONS

MANUAL TROLLIES			
1,000 # CAPACITY	2,000 # CAPACITY	4,000 # CAPACITY	6,000 # CAPACITY
QIT-1	QIT-2	QIT-4	QIT-6
E-MT-1	E-MT-2	E-MT-4	E-MT-6
E-MT-1-C	E-MT-2-C	E-MT-4-C	E-MT-6-C

APPROVAL

I, THE UNDERSIGNED, AGREE THAT THE PRODUCT AS REPRESENTED SATISFIES DESIGN AND DIMENSION REQUIREMENTS. I ALSO ACKNOWLEDGE MY DUTY TO CONFIRM PRODUCT AND INSTALLATION COMPLIANCE WITH ALL APPLICABLE FEDERAL, STATE AND LOCAL REGULATIONS AND STANDARDS.  
**ALL SPECIAL UNITS ARE NON-RETURNABLE**  
[ ] As drawn [ ] As marked

Signed: \_\_\_\_\_ Date: \_\_\_\_\_

LEAD TIME WILL START UPON RECEIPT  
OF SIGNED APPROVAL DRAWING

DISTRIBUTOR'S NAME:

VESTIL MANUFACTURING

DRAWN BY: ND

DATE: 5/21/09

REFERENCE: X

SCALE: 1:36

QUOTED LEAD TIME: X

QUOTE #  
X

P.O.# X

W.O.# X

SALES: X

FILE NAME:

28-007-261

\*\*CAPACITY OF ATTACHMENTS MAY  
DERATE CAPACITY OF GANTRY CRANE